

Please Note:
 The top row should have a
 1/4" gap between segments.
 (Approximately the diameter of a #2 Pencil)

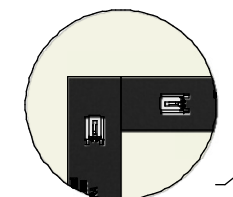

Horizontal
 segments mount
 inside of vertical
 segments

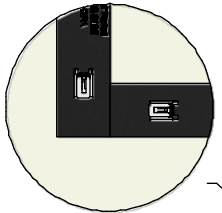

NCAA: Max of
 5" from side of
 backboard to
 center of LEDs

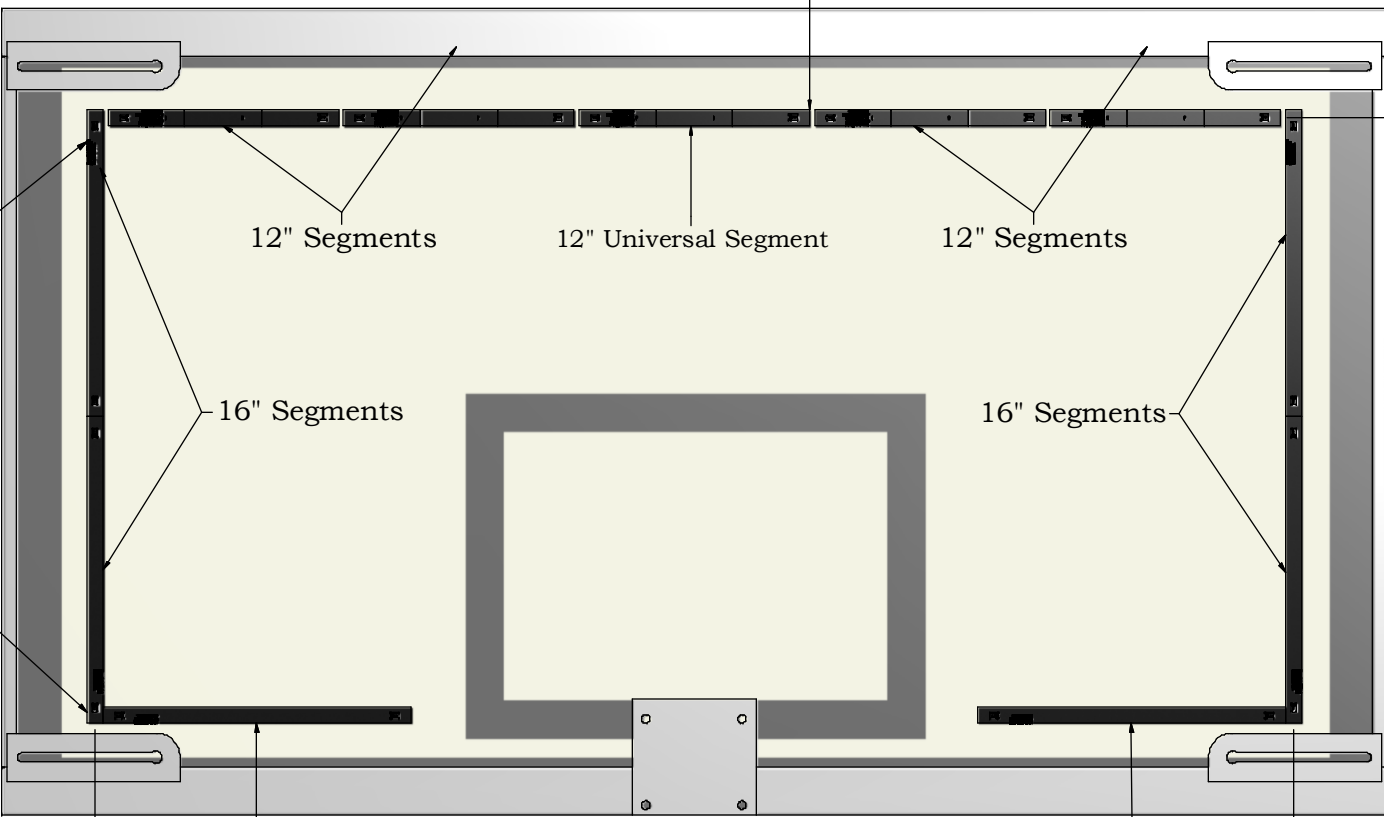

NCAA: Max of
 6" from top of
 backboard to
 center of LEDs

NCAA: Max of
 5" from side of
 backboard to
 center of LEDs

Rear View

72" x 42" Backboard
 Suggested EOP Segment
 Installation Pattern



Nevco, Inc.
 Greenville, Illinois 62246

Drawing No. 241-0380

Drawn MMK

Date 8/30/12

Sheet 1 of 6

Please Note:
The top row should have a
1/4" gap between segments.
(Approximately the diameter of a #2 Pencil)

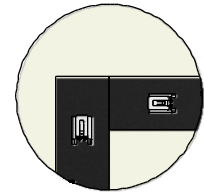

Horizontal segments mount inside of vertical segments

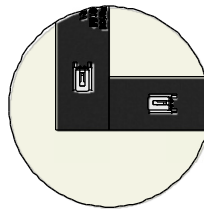

NCAA: Max of 5" from side of backboard to center of LEDs

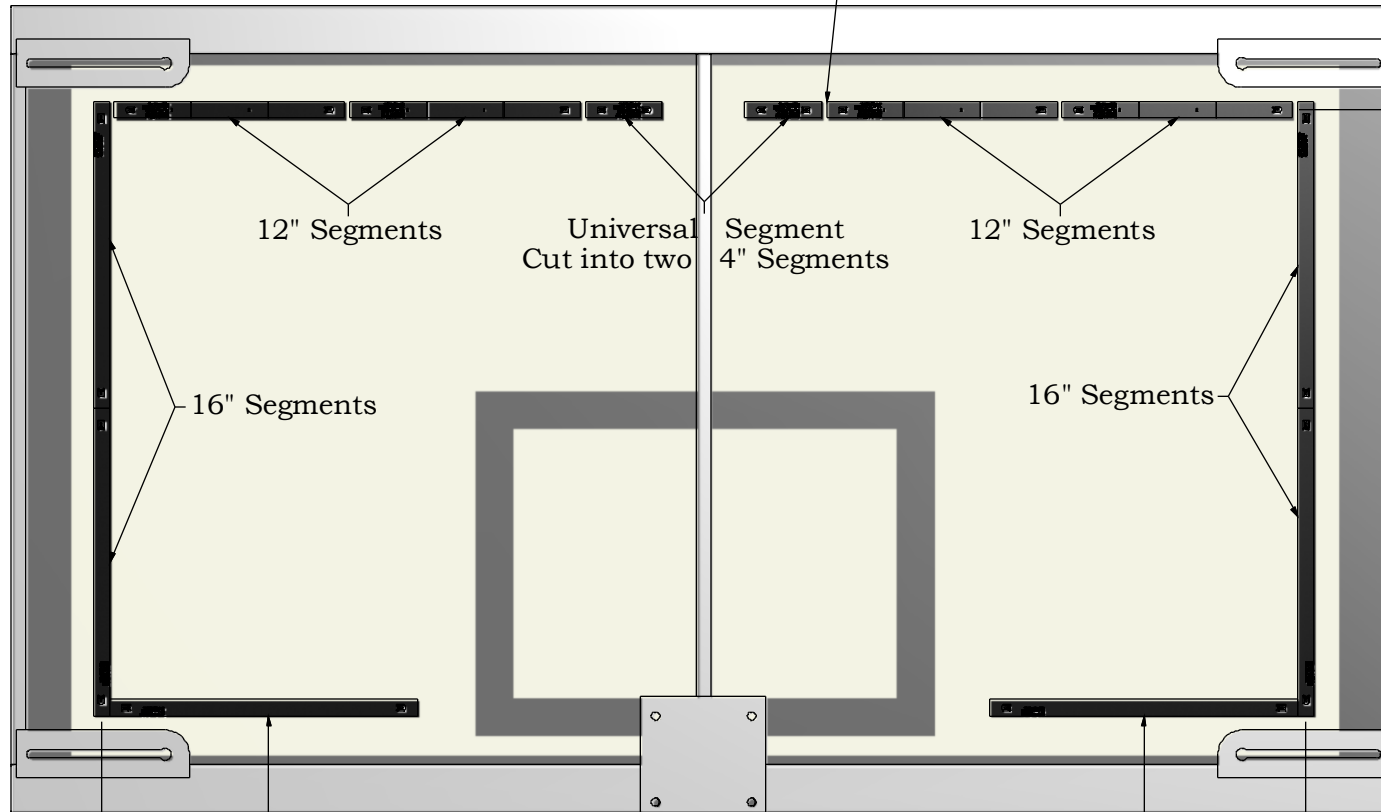

Rear View

NCAA: Max of 6" from top of backboard to center of LEDs

NCAA: Max of 5" from side of backboard to center of LEDs

72" x 42" Backboard
Single Vertical Brace
Suggested EOP Segment
Installation Pattern



Nevco, Inc.
Greenville, Illinois 62246

Drawing No. 241-0380

Drawn MMK

Date 8/30/12

Sheet 2 of 6

Please Note:
The top row should have a
1/4" gap between segments.
(Approximately the diameter of a #2 Pencil)

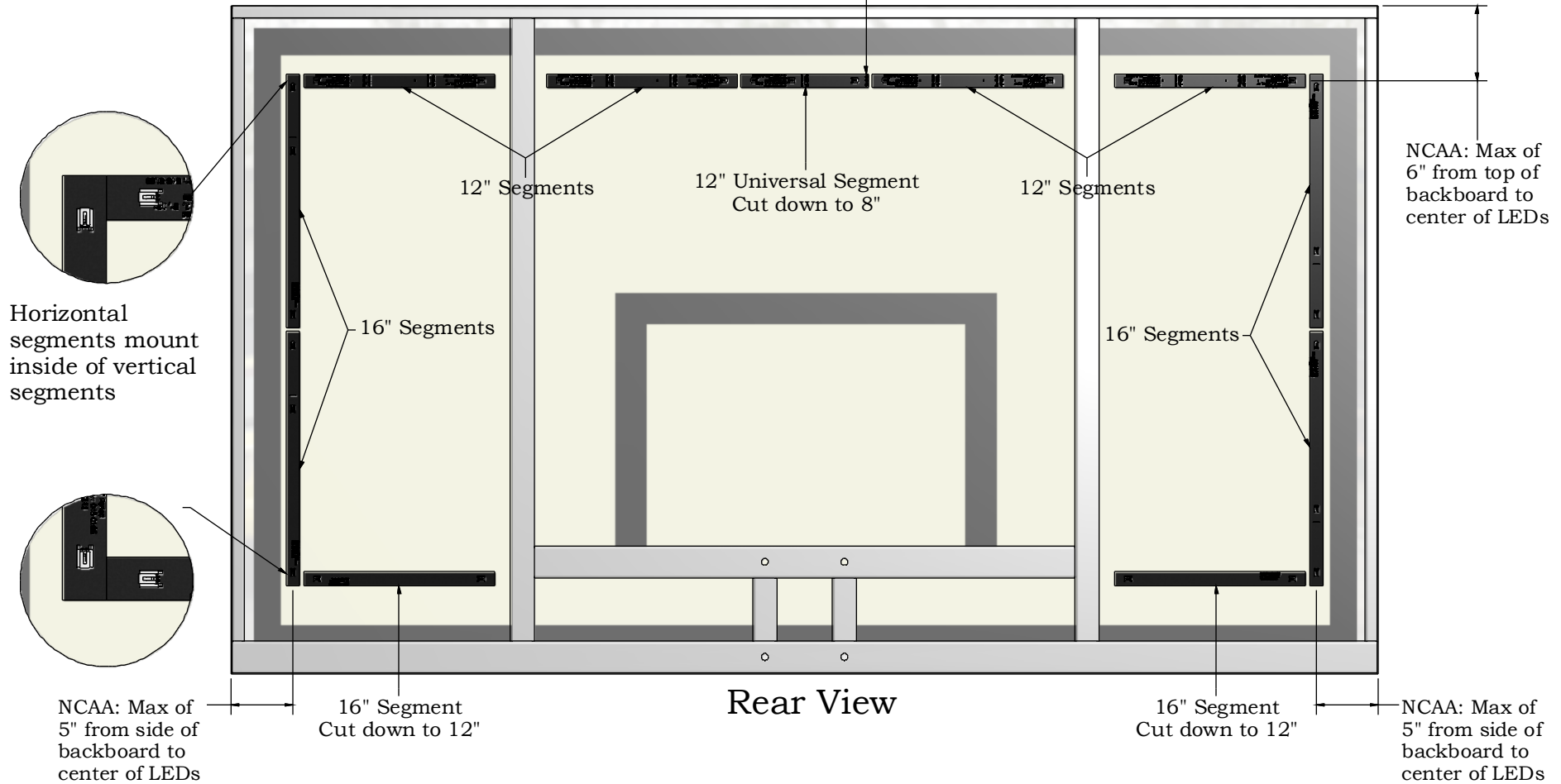

72" x 42" Backboard
Dual Vertical Braces
Suggested EOP Segment
Installation Pattern



Nevco, Inc.
Greenville, Illinois 62246

Drawing No. 241-0310

Drawn MMK

Date 8/30/12

Sheet 3 of 6

Please Note:
The top row should have a
1/4" gap between segments.
(Approximately the diameter of a #2 Pencil)

NCAA: Max of
6" from top of
backboard to
center of LEDs

Horizontal
segments mount
inside of vertical
segments

4" Universal Segment
Section with 2 plugs
(See manual for info)

12" Segments

12" Universal Segment

12" Segments

4" Universal Segment
Section with 2 plugs
(See manual for info)

16"
Segments

16"
Segments

Horizontal
segments mount
inside of vertical
segments

NCAA: Max of
5" from side of
backboard to
center of LEDs

NCAA: Max of
5" from side of
backboard to
center of LEDs

Rear View

72" x 48" Backboard
Suggested EOP Segment
Installation Pattern



Nevco, Inc.
Greenville, Illinois 62246

Drawing No. 241-0380

Drawn MMK

Date 8/30/12

Sheet 4 of 6

Please Note:
The top row should have a
1/4" gap between segments.
(Approximately the diameter of a #2 Pencil)

NCAA: Max of
6" from top of
backboard to
center of LEDs

Horizontal
segments mount
inside of vertical
segments

4" Universal Segment
Section with 2 plugs
(See manual for info)

12" Segments

12" Segments

4" Universal Segment
Section with 2 plugs
(See manual for info)

4" Universal Segment
Section with 2 plugs
(See manual for info)

16"
Segments

16"
Segments

Horizontal
segments mount
inside of vertical
segments

NCAA: Max of
5" from side of
backboard to
center of LEDs

NCAA: Max of
5" from side of
backboard to
center of LEDs

Rear View

72" x 48" Backboard
Single Vertical Brace
Suggested EOP Segment
Installation Pattern



Nevco, Inc.
Greenville, Illinois 62246

Drawing No. 241-0380

Drawn MMK

Date 8/30/12

Sheet 5 of 6

Please Note:
The top row should have a
1/4" gap between segments.
(Approximately the diameter of a #2 Pencil)

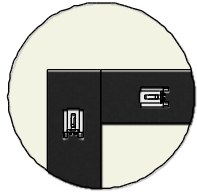

Horizontal
segments mount
inside of vertical
segments

4" Universal Segment
Section with 2 plugs
(See manual for info)

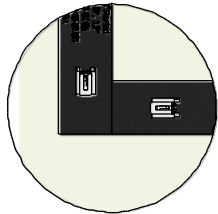

Horizontal
segments mount
inside of vertical
segments

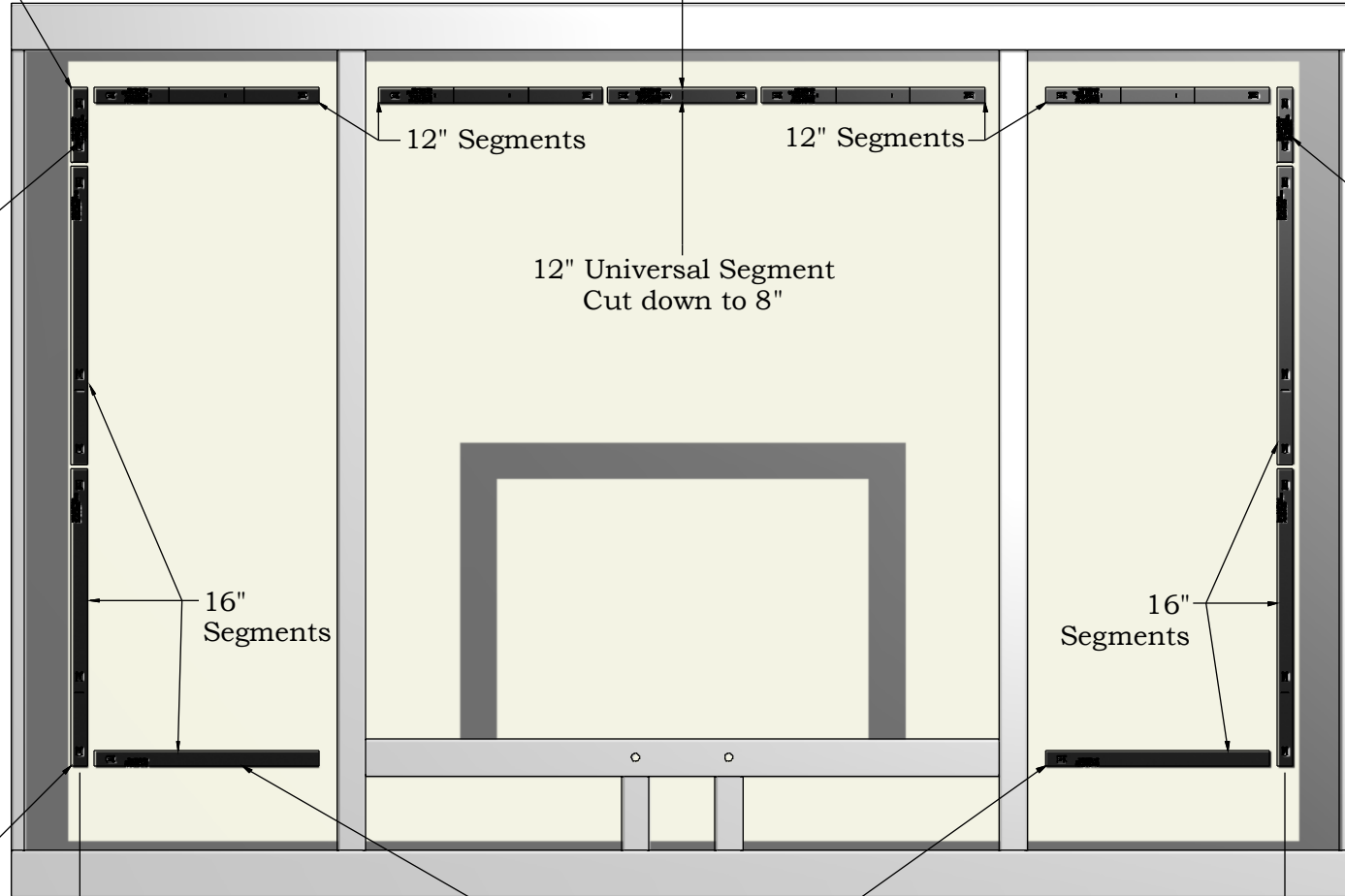

4" Universal Segment
Section with 2 plugs
(See manual for info)

NCAA: Max of
5" from side of
backboard to
center of LEDs

NCAA: Max of
5" from side of
backboard to
center of LEDs

Rear View

16" Segment cut
down to 12"

72" x 48" Backboard
Dual Vertical Braces
Suggested EOP Segment
Installation Pattern



Nevco, Inc.
Greenville, Illinois 62246

Drawing No. 241-0380

Drawn MMK

Date 8/30/12

Sheet 6 of 6